

JGB8 400W伺服電機 單軸/1-axis

▶ 軌道內嵌
Built-in Guideway

▶ 皮帶驅動
Belt Drive



此圖僅供參考，出貨規格詳見尺寸圖面
The picture is just for the reference. Please check the the actual dimensions on the drawing.

最大行程
Maximum Stroke **1250mm**

最高速度
Maximum Speed **2000mm/s**

馬達容量
Motor Output **400W**

皮帶寬度
Belt Width **15mm**

型號表示方式 Ordering Method

JGB8 - L48 - 100 - BL - T400W - C 4 - MB-3M

本體型號
Model

導程
Lead

48 48mm

行程
Stroke

50-1250mm

50間隔 50 mm Pitch

馬達位置
Motor Position

BW	馬達上折 Motor Top Fold
BM	馬達下折 Motor Bottom Side
BL	馬達左折 Motor Left Side
BR	馬達右折 Motor Right Side

電機安裝標準
Motor installation

T	通用馬達安裝標準: 三菱 Mitsubishi
	台達 Delta
	安川 Yaskawa
	汇川 Inovance
	等等 Etc
P	松下馬達安裝標準

馬達容量
Motor Output

100W	-
200W	-
400W	400W

原點感應器
Home Sensor

	外掛型 Out Side
C	馬達側 Motor Side
D	反馬達側 Opposite Motor Side
	無 SENSOR No Sensor
E	無 SENSOR No Sensor

端點極限感應器
Limit Sensor

	外掛型 Out Side
3	1只 1 Pc
4	2只 2 Pc
	無 SENSOR No Sensor
5	無 SENSOR No Sensor

馬達廠牌
Motor Brand

MB-3M	含電機, 廠家安裝三菱帶制 車電機, 線長3米
ZMB	不含電機, 客戶自己安裝三 菱帶制車電機
KMB	不含電機, 客戶提供三菱帶 制車電機, 廠家安裝

※若無煞車則B不表示。
※If No Brake, No B Description.

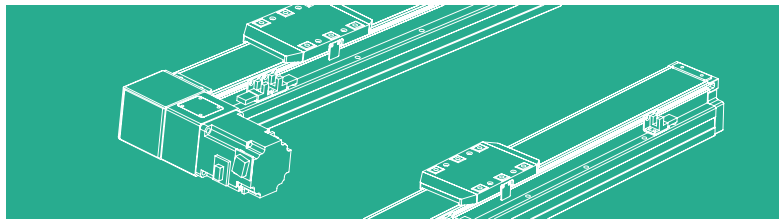

基本仕様 Specification

規格 Spec	位置重複精度 Repeatability (mm)	±0.04		
	導程 Lead (mm)	48		
	最高速度 Maximum Speed (mm/s)	2000		
	最大可搬重量 Maximum Payload	水平使用 Horizontal (kg)	15	
		垂直使用 Vertical (kg)		
	定格推力 Rated Thrust (N)	85		
標準行程 Stroke Pitch (mm)	50-1250mm/50間隔 50 mm Pitch			
部品 Parts	AC伺服馬達容量 AC Servo Motor Output (W)	400		
	皮帶寬度 Belt Width	15		
	高剛性直線滑軌 High Rigidity Linear Guide (mm)	10X14		
	原點感應器 Home Sensor	外掛 Outside	EE-SX674(NPN) FC-SPX307Z-2M(NPN)	

感應器接線圖 <原點及端點> Sensor Layout

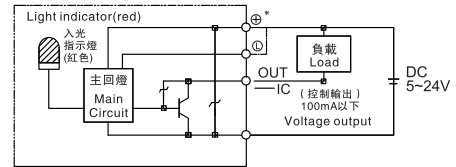

*馬達加減速設定0.4秒
*Acceleration and deceleration value is set 0.4 second.

容許負載力距表 Allowable Overhang

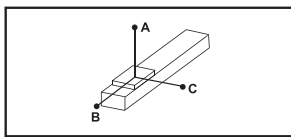

(單位 Unit : mm)

水平安裝 Horizontal Installation	A	B	C
5kg	850	322	395
10kg	560	185	226
15kg	473	135	156

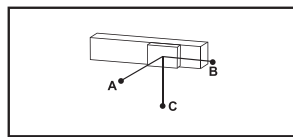

(單位 Unit : mm)

壁掛安裝 Wall Installation	A	B	C
5kg	355	310	532
10kg	210	196	455
15kg	171	155	435

靜態容許負載慣量 Static Loading Moment

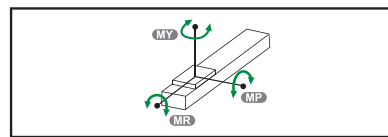

(單位 Unit : N.m)

MY	318
MP	318
MR	626

*力距表所表示的數據，代表重心。

The torque value in the chart indicate the center of gravity.

*符合型錄規範的正常使用下，保證壽命為10000公里。

Operation life is 10,000km when the product is using under the specified conditions.

*倒吊使用無法套用標準規範，如有需求請洽詢我司業務。

Data information is not for ceiling-mount inverse use.

Contact us for the details if you want to apply ceiling-mount inverse usage.

搭配伺服馬達一覽表 Suitable Motor Brand

廠牌 Brand	馬達記號 Mark	煞車有無 Brake	馬達容量 Watt	電源電壓 AC-Voltage	伺服馬達型號 Motor Model	驅動器型號 Driver Model
三菱 Mitsubishi	M	無煞車(水平仕様) No Brake (Horizontal Type)	400	220	HG-KN43J-S100	MR-JE-40A
松下 Panasonic	P	無煞車(水平仕様) No Brake (Horizontal Type)	400	220	MHMF042L1U2M	MBDLN25SE
台達 Delta	T	無煞車(水平仕様) No Brake (Horizontal Type)	400	220	ECM-B3M-C20604RS1	ASD-B3-0421-L

JGB8 單軸/1-axis

▶ 軌道內嵌
Built-in Guideway

▶ 皮帶驅動
Belt Drive

馬達上折/馬達下折

Motor Upper Side / Motor Bottom Side

BW 馬達上折 Motor Upper Side



單位 Unit : mm

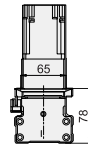
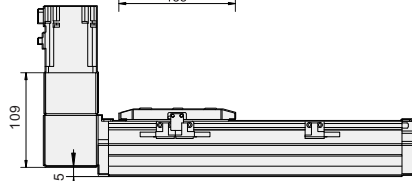
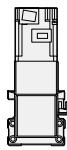
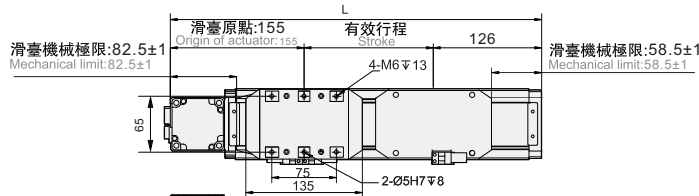

※行程 50 時，因本體上鎖式固定孔會被滑座遮住，僅能使用 4 支螺絲固定，建議客戶本體使用下鎖式固定孔鎖附。
When the stroke is 50mm, if fixing the body from the top to the bottom, the fixing hole will be blocked by slider and only can be uses 4 screws to fix as a result, suggest that fixing actuator body from the bottom to the top.

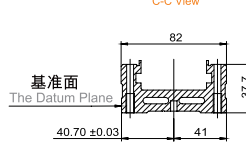
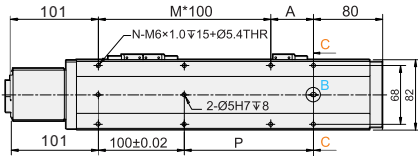
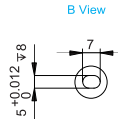

有效行程 Stroke	50	100	150	200	250	300	350	400	450	500	550	600	650	700	750	800	850	900	950	1000	1050	1100	1150	1200	1250	
L	331	381	431	481	531	581	631	681	731	781	831	881	931	981	1031	1081	1131	1181	1231	1281	1331	1381	1431	1481	1531	
A	50	100	50	100	50	100	50	100	50	100	50	100	50	100	50	100	50	100	50	100	50	100	50	100	50	
M	1	1	2	2	3	3	4	4	5	5	6	6	7	7	8	8	9	9	10	10	10	11	11	12	12	13
N	6	6	8	8	10	10	12	12	14	14	16	16	18	18	20	20	22	22	24	24	24	26	26	28	28	30
P	50	100	150	200	250	300	360	400	450	500	550	600	650	700	750	800	850	900	950	1000	1050	1100	1150	1200	1250	
KG	3.15	3.42	3.69	3.97	4.25	4.52	4.8	5.07	5.35	5.63	5.9	6.17	6.44	6.71	6.98	7.25	7.52	7.79	8.06	8.33	8.6	8.87	9.14	9.41	9.68	

BM 馬達下折 Motor Bottom Side



單位 Unit : mm

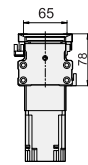
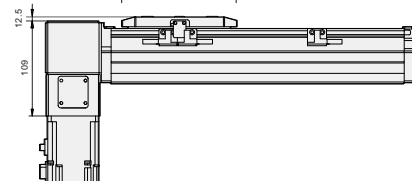
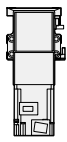
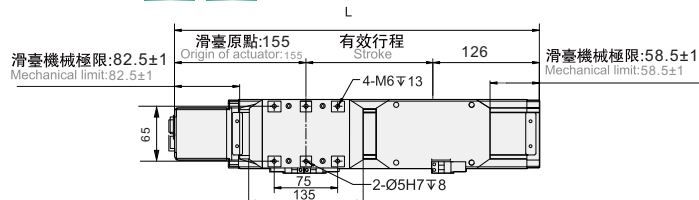

※行程 50 時，因本體上鎖式固定孔會被滑座遮住，僅能使用 4 支螺絲固定，建議客戶本體使用下鎖式固定孔鎖附。
When the stroke is 50mm, if fixing the body from the top to the bottom, the fixing hole will be blocked by slider and only can be uses 4 screws to fix as a result, suggest that fixing actuator body from the bottom to the top.

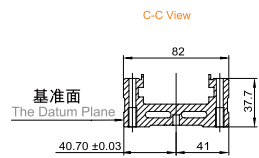
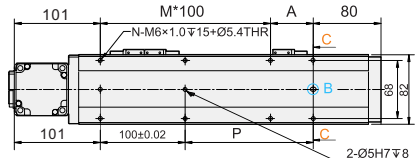
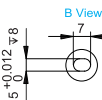

有效行程 Stroke	50	100	150	200	250	300	350	400	450	500	550	600	650	700	750	800	850	900	950	1000	1050	1100	1150	1200	1250	
L	331	381	431	481	531	581	631	681	731	781	831	881	931	981	1031	1081	1131	1181	1231	1281	1331	1381	1431	1481	1531	
A	50	100	50	100	50	100	50	100	50	100	50	100	50	100	50	100	50	100	50	100	50	100	50	100	50	
M	1	1	2	2	3	3	4	4	5	5	6	6	7	7	8	8	9	9	10	10	10	11	11	12	12	13
N	6	6	8	8	10	10	12	12	14	14	16	16	18	18	20	20	22	22	24	24	24	26	26	28	28	30
P	50	100	150	200	250	300	360	400	450	500	550	600	650	700	750	800	850	900	950	1000	1050	1100	1150	1200	1250	
KG	3.15	3.42	3.69	3.97	4.25	4.52	4.8	5.07	5.35	5.63	5.9	6.17	6.44	6.71	6.98	7.25	7.52	7.79	8.06	8.33	8.6	8.87	9.14	9.41	9.68	

馬達左折/馬達右折

Motor Left Side / Motor Right Side

BL 馬達左折 Motor Left Side



單位 Unit : mm

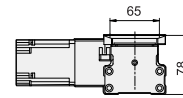
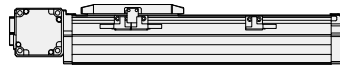
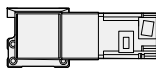
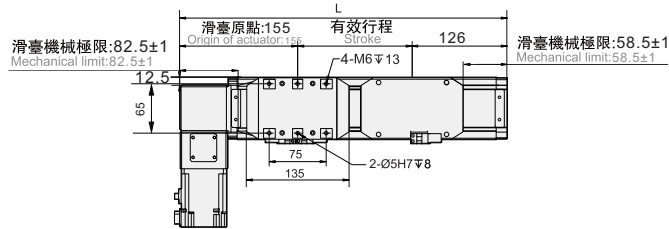

※行程 50 時，因本體上鎖式固定孔會被滑座遮住，僅能使用 4 支螺絲固定，建議客戶本體使用下鎖式固定孔鎖附。
When the stroke is 50mm, if fixing the body from the top to the bottom, the fixing hole will be blocked by slider and only can be uses 4 screws to fix; as a result, suggest that fixing actuator body from the bottom to the top.

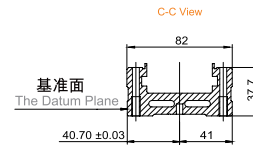
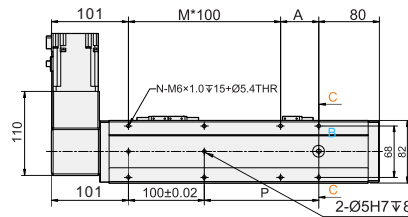
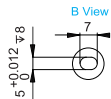

有效行程 Stroke	50	100	150	200	250	300	350	400	450	500	550	600	650	700	750	800	850	900	950	1000	1050	1100	1150	1200	1250
L	331	381	431	481	531	581	631	681	731	781	831	881	931	981	1031	1081	1131	1181	1231	1281	1331	1381	1431	1481	1531
A	50	100	50	100	50	100	50	100	50	100	50	100	50	100	50	100	50	100	50	100	50	100	50	100	50
M	1	1	2	2	3	3	4	4	5	5	6	6	7	7	8	8	9	9	10	10	11	11	12	12	13
N	6	6	8	8	10	10	12	12	14	14	16	16	18	18	20	20	22	22	24	24	26	26	28	28	30
P	50	100	150	200	250	300	360	400	450	500	550	600	650	700	750	800	850	900	950	1000	1050	1100	1150	1200	1250
KG	3.15	3.42	3.69	3.97	4.25	4.52	4.8	5.07	5.35	5.63	5.9	6.17	6.44	6.71	6.98	7.25	7.52	7.79	8.06	8.33	8.6	8.87	9.14	9.41	9.68

BR 馬達右折 Motor Right Side



單位 Unit : mm

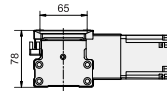
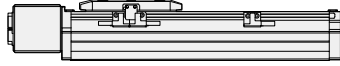
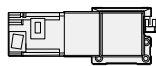
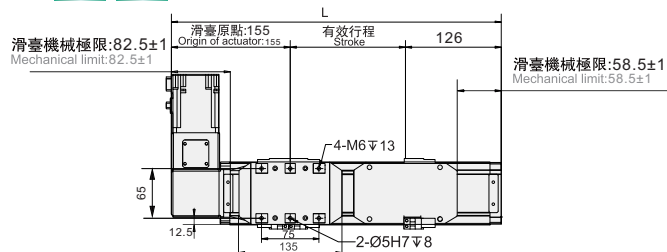

※行程 50 時，因本體上鎖式固定孔會被滑座遮住，僅能使用 4 支螺絲固定，建議客戶本體使用下鎖式固定孔鎖附。
When the stroke is 50mm, if fixing the body from the top to the bottom, the fixing hole will be blocked by slider and only can be uses 4 screws to fix; as a result, suggest that fixing actuator body from the bottom to the top.

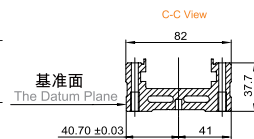
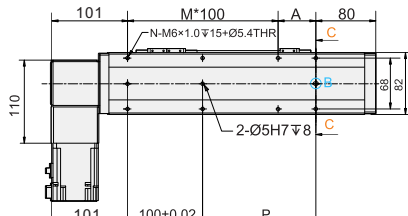
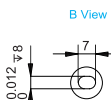

有效行程 Stroke	50	100	150	200	250	300	350	400	450	500	550	600	650	700	750	800	850	900	950	1000	1050	1100	1150	1200	1250
L	331	381	431	481	531	581	631	681	731	781	831	881	931	981	1031	1081	1131	1181	1231	1281	1331	1381	1431	1481	1531
A	50	100	50	100	50	100	50	100	50	100	50	100	50	100	50	100	50	100	50	100	50	100	50	100	50
M	1	1	2	2	3	3	4	4	5	5	6	6	7	7	8	8	9	9	10	10	11	11	12	12	13
N	6	6	8	8	10	10	12	12	14	14	16	16	18	18	20	20	22	22	24	24	26	26	28	28	30
P	50	100	150	200	250	300	360	400	450	500	550	600	650	700	750	800	850	900	950	1000	1050	1100	1150	1200	1250
KG	3.15	3.42	3.69	3.97	4.25	4.52	4.8	5.07	5.35	5.63	5.9	6.17	6.44	6.71	6.98	7.25	7.52	7.79	8.06	8.33	8.6	8.87	9.14	9.41	9.68